

DC SERVO Motor

KL34-180-72

UNIT=MM:

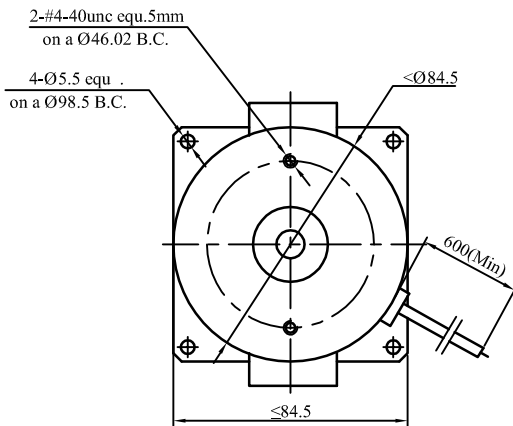
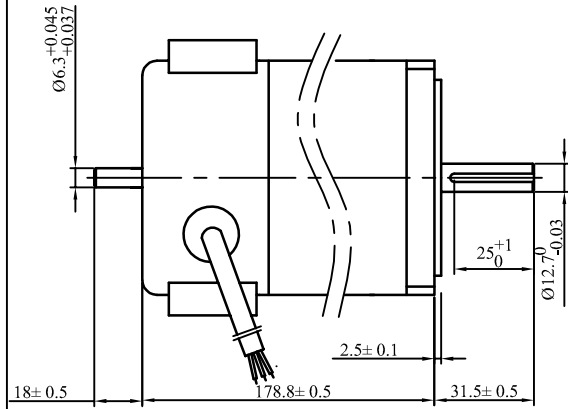
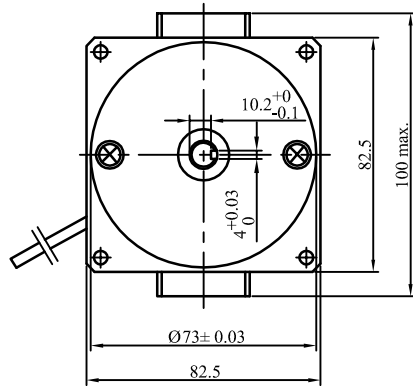

-Skewed Rotor Design

- constant torque: 1.6 N.m (226 oz-in)
- peak torque: 8.0 N.m (1125 oz-in)
- max. speed at voltage constant: 4000 rpm
- terminal voltage: 72 VDC
- continuous current: 7.8A
- peak current: > 40A
- torque constant (KT): 0.182 Nm/am
- voltage constant(KE): 18.95 V/100rpm
- resistance: 0.925 ohm
- inductance: 2.5 mh
- inertia: 3.4 kg/cm²
- weight: 4.25kg